

Creating a Built-in Barbecue

Reference Number: **KB-02693**

Last Modified: **July 21, 2021**

The information in this article applies to:



QUESTION

How can I create a built-in barbecue in Home Designer?



ANSWER

Use a variety of cabinets and built-in appliances from the library to create a built-in barbecue using Home Designer.

To set plan defaults

1. Start by creating a **New Plan** .

2. Select **Edit> Default Settings**  from the menu.
3. Navigate to **Cabinets> Base Cabinet**, then click the **Edit** button.
4. On the **GENERAL** panel of the **Base Cabinet Defaults** dialog, set the **Overhang** to 0".

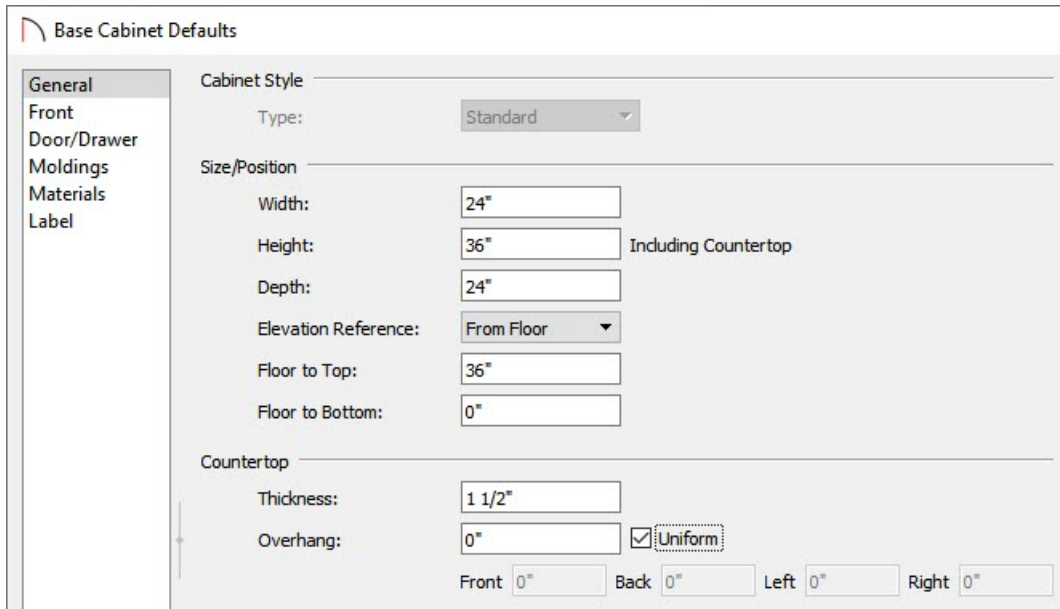

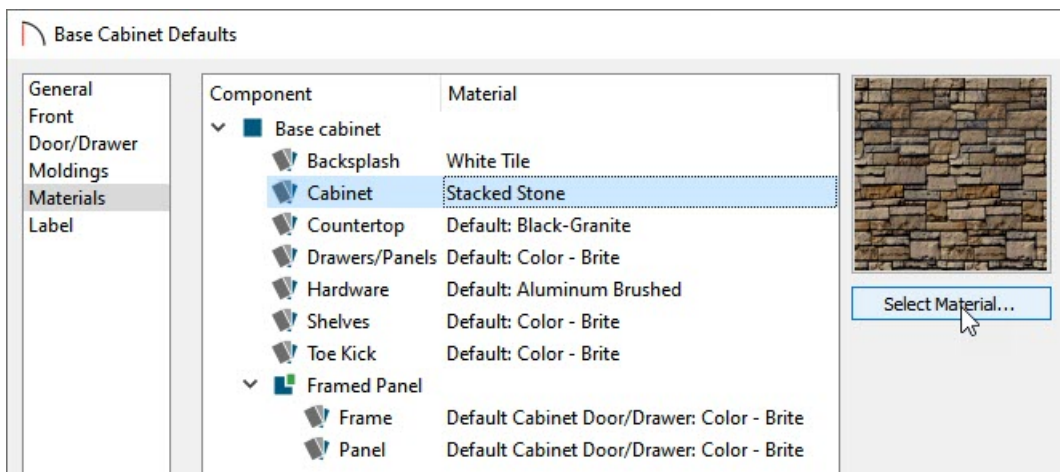

5. On the **MATERIALS** panel, select the **Cabinet** component, then click on the **Select Material** button to browse for a new material. In this example, Stacked Stone is used.



6. Remaining on the **MATERIALS** panel, select the **Countertop** component, then click on the **Select Material** button to browse for a new material. In this example, we used Buff-Stone.
7. Once the defaults have been set, click **OK**, then click **Done**.

To place the cabinets for the barbecue

1. Next, select **Build> Cabinet> Base Cabinet**  and click in the plan to place base cabinets.
2. Some cabinets may be different widths than others. To change the width, select the cabinet using the **Select Objects**  tool, click on the **Open Object**  edit button, and on the **GENERAL** panel of the **Cabinet Specification** dialog that displays, increase the **Width**.

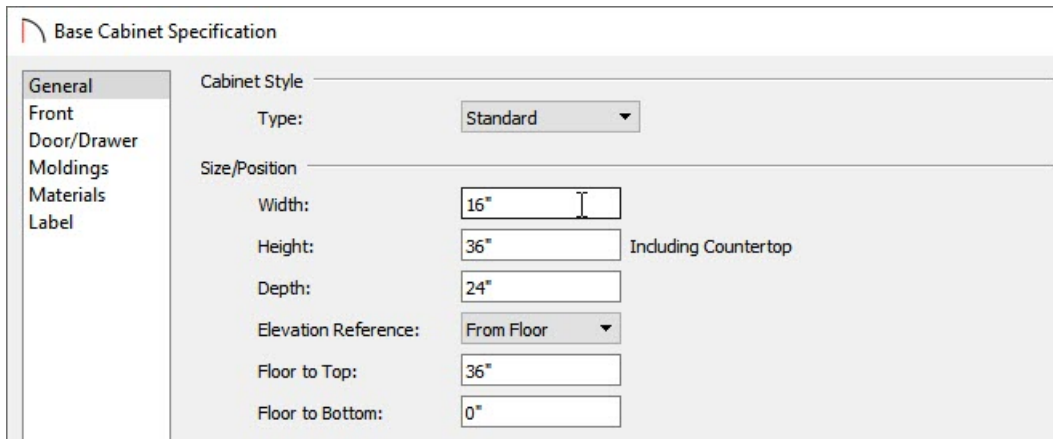

3. Here is how we defined the cabinets in this example.

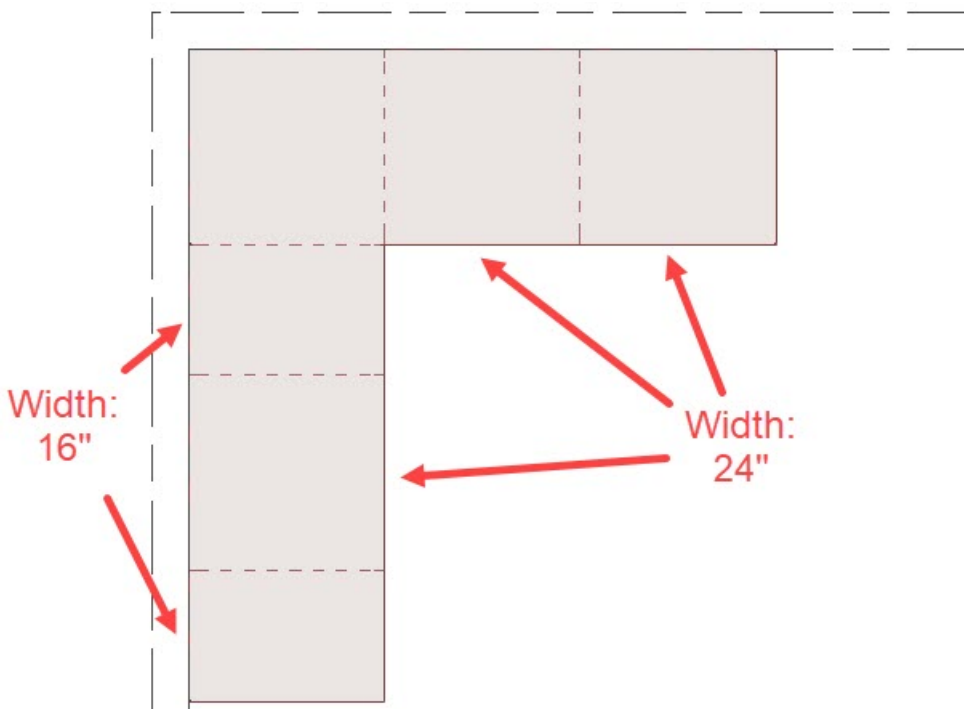

To modify the cabinets

1. Select one of the cabinets and click on **Open Object**  edit button.
2. On the **FRONT** panel of the **Base Cabinet Specification** dialog that displays, click on the drawer in the cabinet preview on the right.

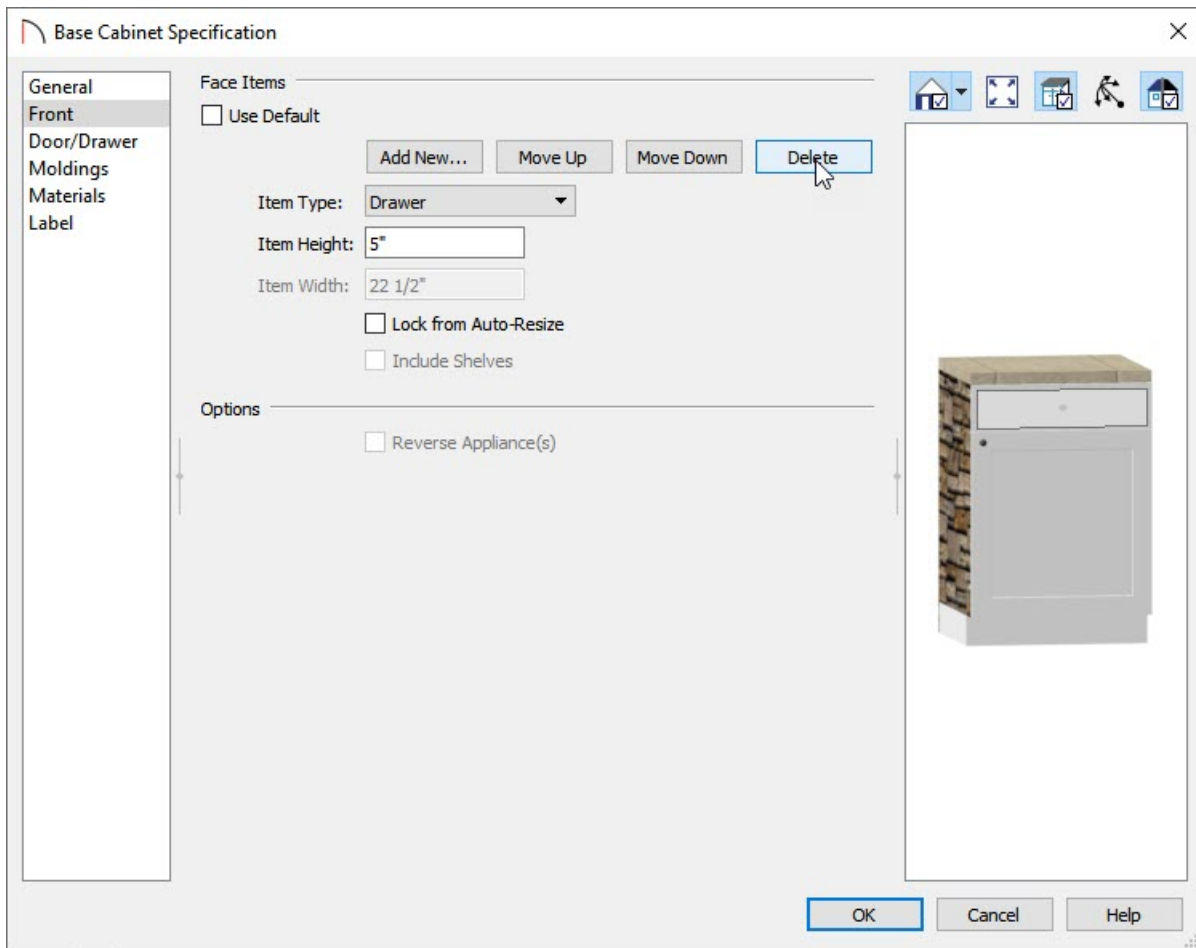

- Click the **Delete** button to remove the drawer.
- Repeat the process for the door on the cabinet
- Once the door and drawer have been removed from the cabinet, click on the open area and change the **Item Type** from **Opening** to **Blank Area**.

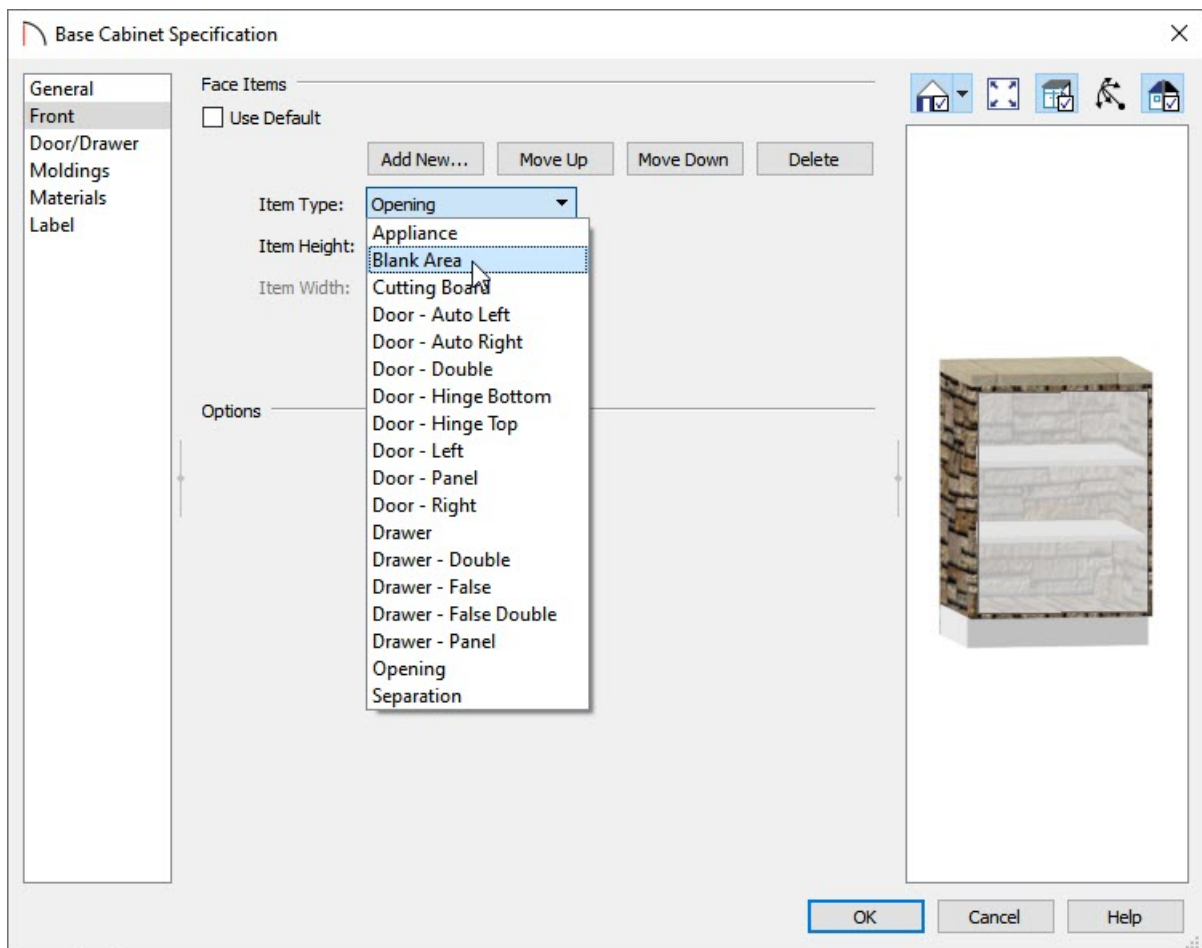

To place the barbecue

1. Select **View> Library Browser** , then find the barbecue grill in the library by doing a search for **BBQ**.

In this example the **BBQ (built-in, gas)** was used.

2. Once you have found the barbecue, select it and then click on the cabinet to place it in the plan .

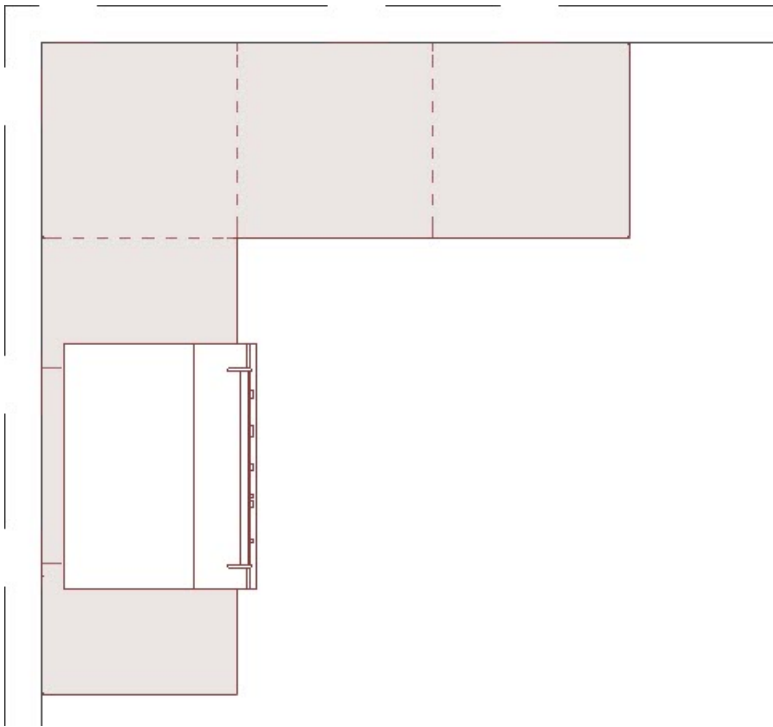

3. You're now ready to continue customizing your barbecue area using additional cabinetry and items from the Library Browser.

Related Articles

- [📄 Creating a Covered Patio \(/support/article/KB-01010/creating-a-covered-patio.html\)](/support/article/KB-01010/creating-a-covered-patio.html)
- [📄 Creating a Screen Porch \(/support/article/KB-00748/creating-a-screen-porch.html\)](/support/article/KB-00748/creating-a-screen-porch.html)
- [📄 Creating an Outdoor Kitchen \(/support/article/KB-00984/creating-an-outdoor-kitchen.html\)](/support/article/KB-00984/creating-an-outdoor-kitchen.html)
- [📄 Modeling a Brick Patio \(/support/article/KB-00910/modeling-a-brick-patio.html\)](/support/article/KB-00910/modeling-a-brick-patio.html)