

Creating Custom Driveways and Sidewalks

Reference Number: **KB-00774**

Last Modified: **October 6, 2023**

The information in this article applies to:



QUESTION



How do I create custom driveways and sidewalks?



ANSWER

Driveways and sidewalks can be drawn using the Road and Sidewalk terrain tools. Road and Sidewalk features follow the slopes of your terrain so you can easily create a wide variety of designs for your home's exterior.

To add a custom driveway

1. Create a Terrain Perimeter by clicking **Terrain> Create Terrain Perimeter** , if you don't already have one.
2. Select **Terrain> Road and Sidewalk> Driveway Area**  from the menu.
3. Left-click near the top left corner of the garage and drag down and to the left to create the first part of the driveway.

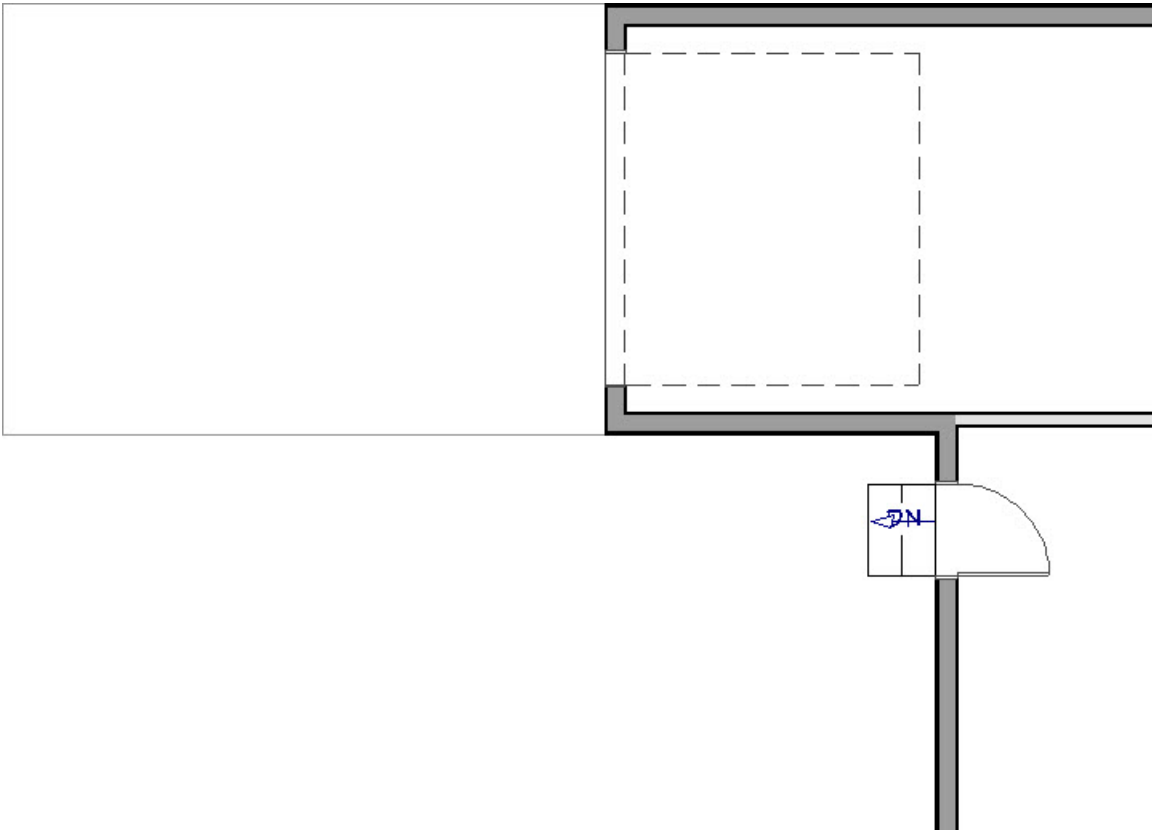

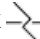
4. To create a turn in the driveway:
 - Click to select the driveway, select the **Add Break**  tool from the Edit Toolbar, then left-click along the bottom edge of the driveway to place break.

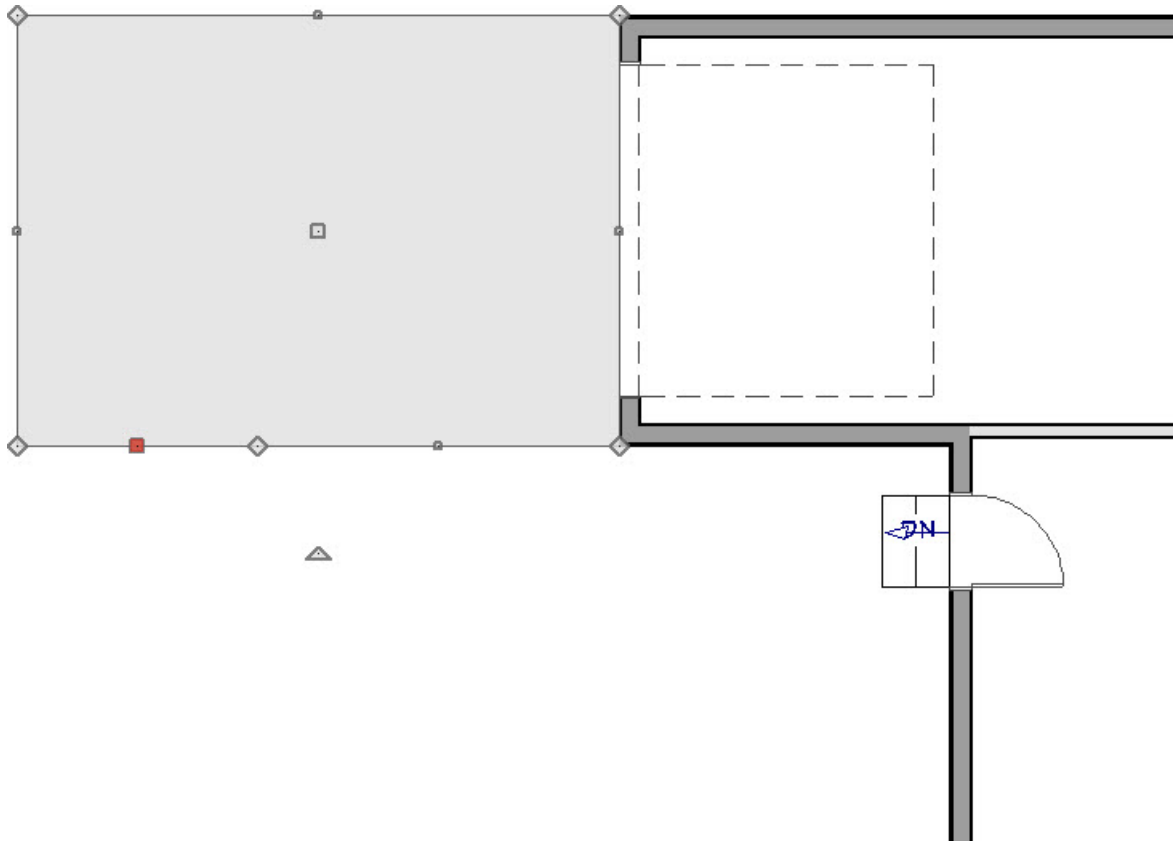

- Select and drag the left line segment downward, as shown in the image below.

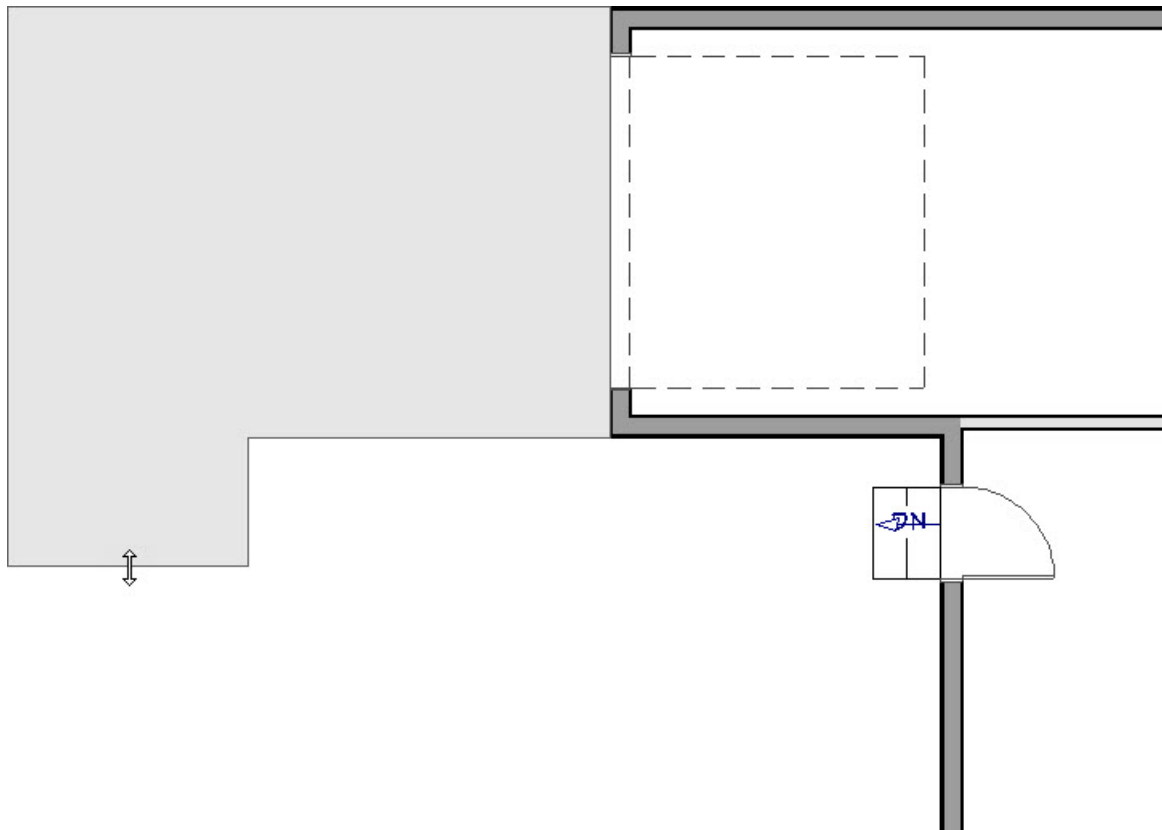

5. To curve the corner of the driveway:

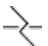

- Select the driveway and click the **Add Break**  edit tool.
- Place a break in from the upper left corner of the driveway.

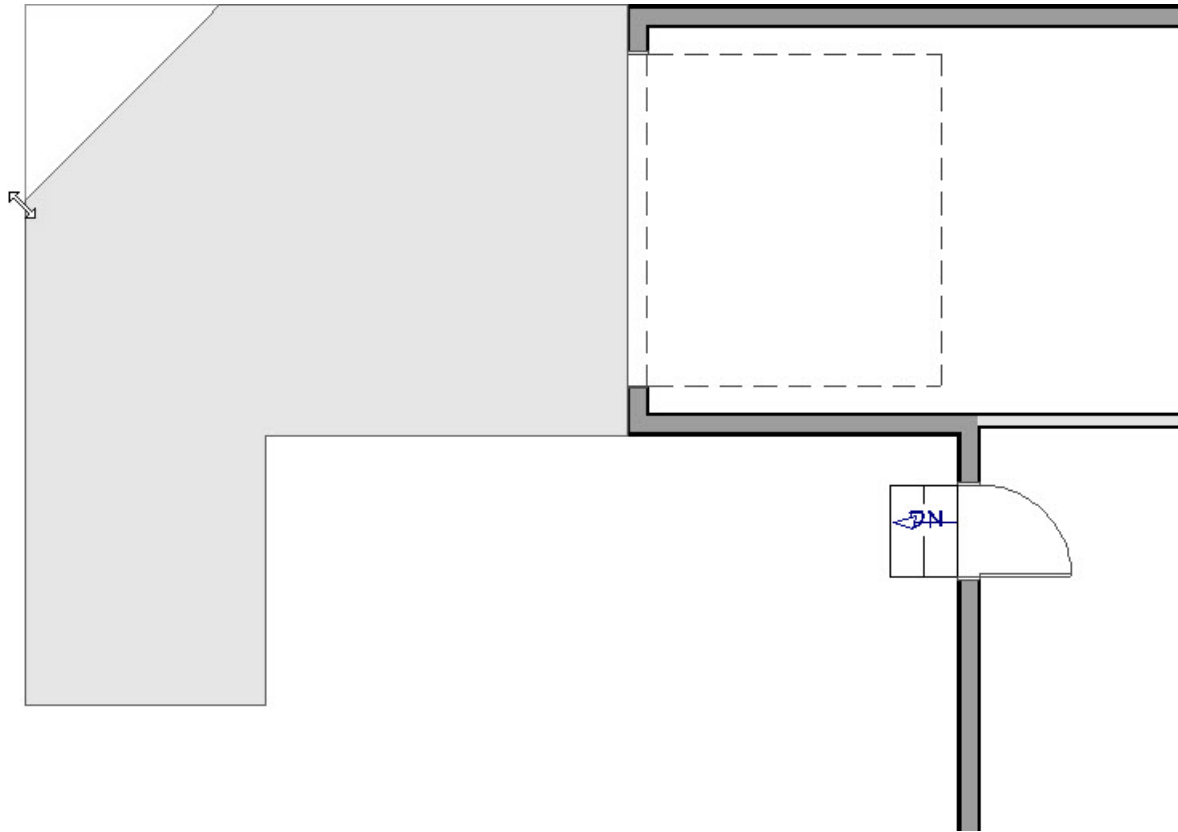
- Click and drag the diamond shaped move handle on the corner down to create a 45° angle.

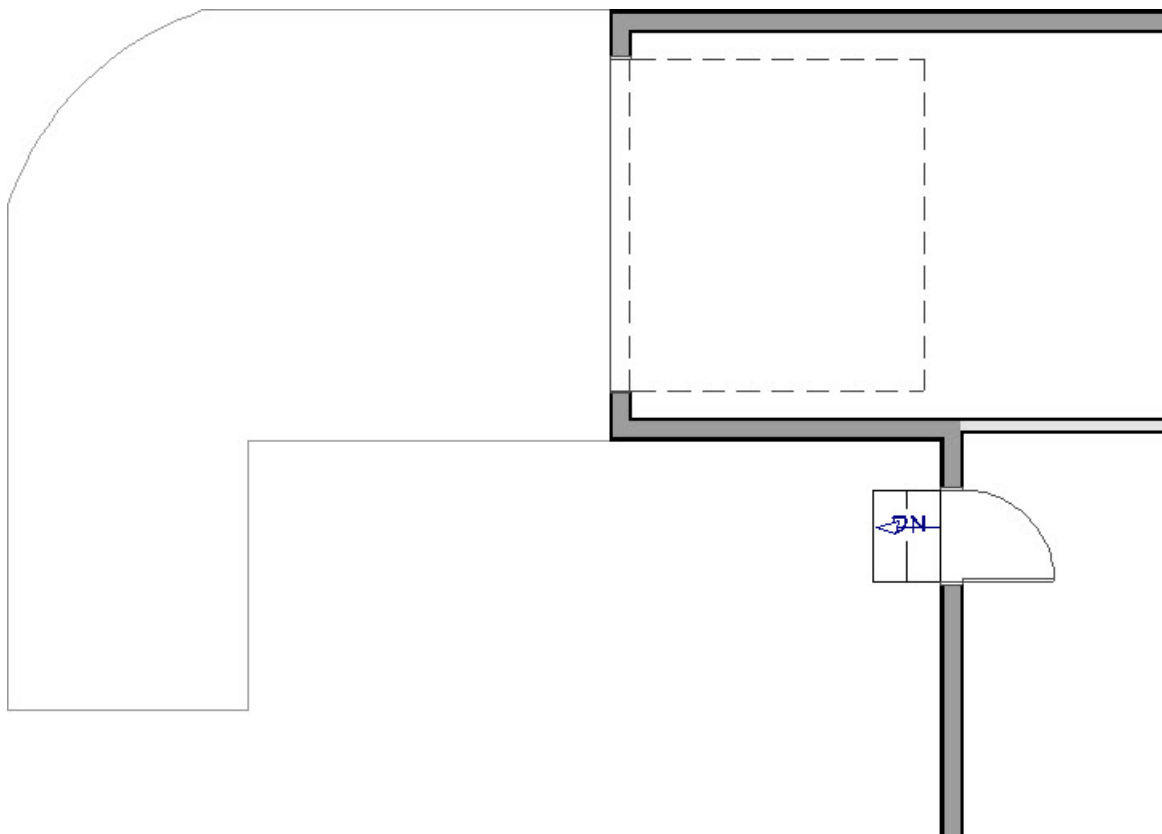

- With the angled edge selected go to the edit toolbar and click the **Change Line/Arc**  edit button to create the curve. The shape of the curve can be adjusted using the edit handles.



6. With the **Select Objects**  tool, click on the driveway, click on **Open Object**  to open the **Terrain Feature**

Specification dialog where the **Thickness** and **MATERIALS** can be changed to your liking.

To create a custom sidewalk

1. Select **Terrain > Road and Sidewalk > Straight Sidewalk**  from the menu.
2. Click and drag a line from the center of your entry stairs.

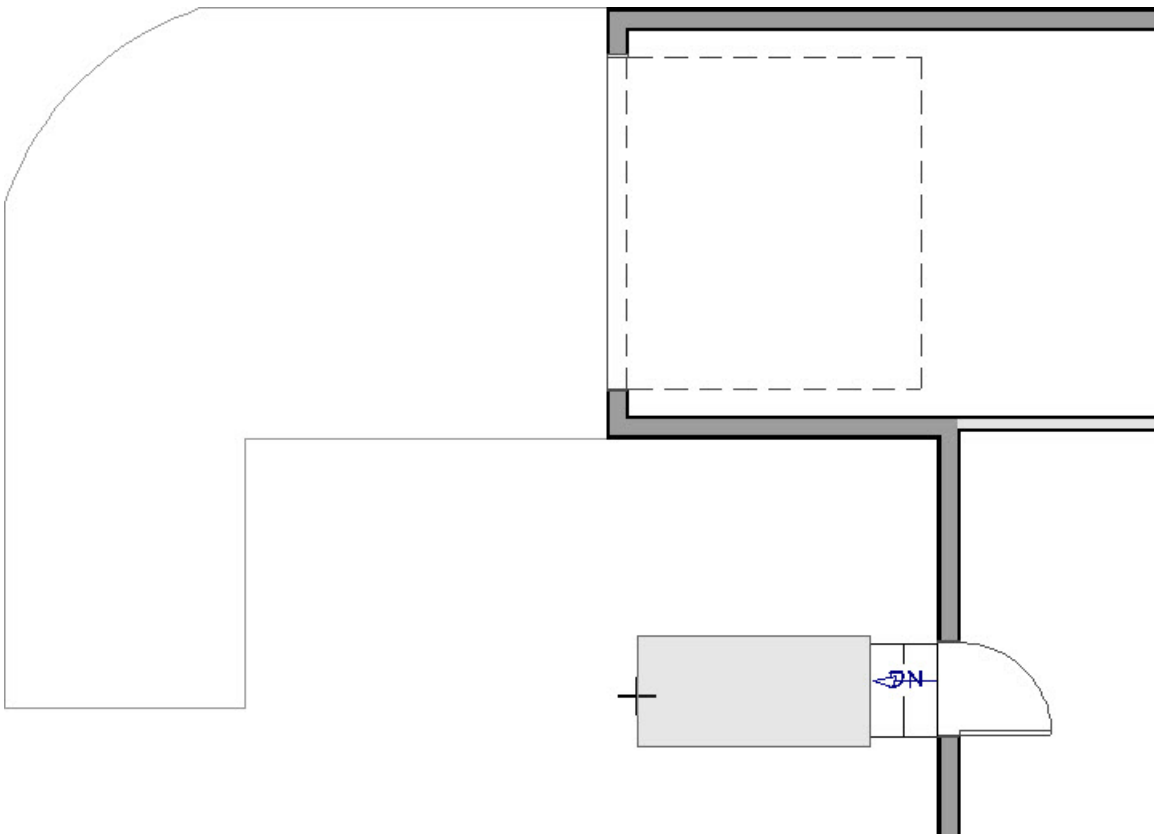

3. Click and drag a smaller, 45° segment.

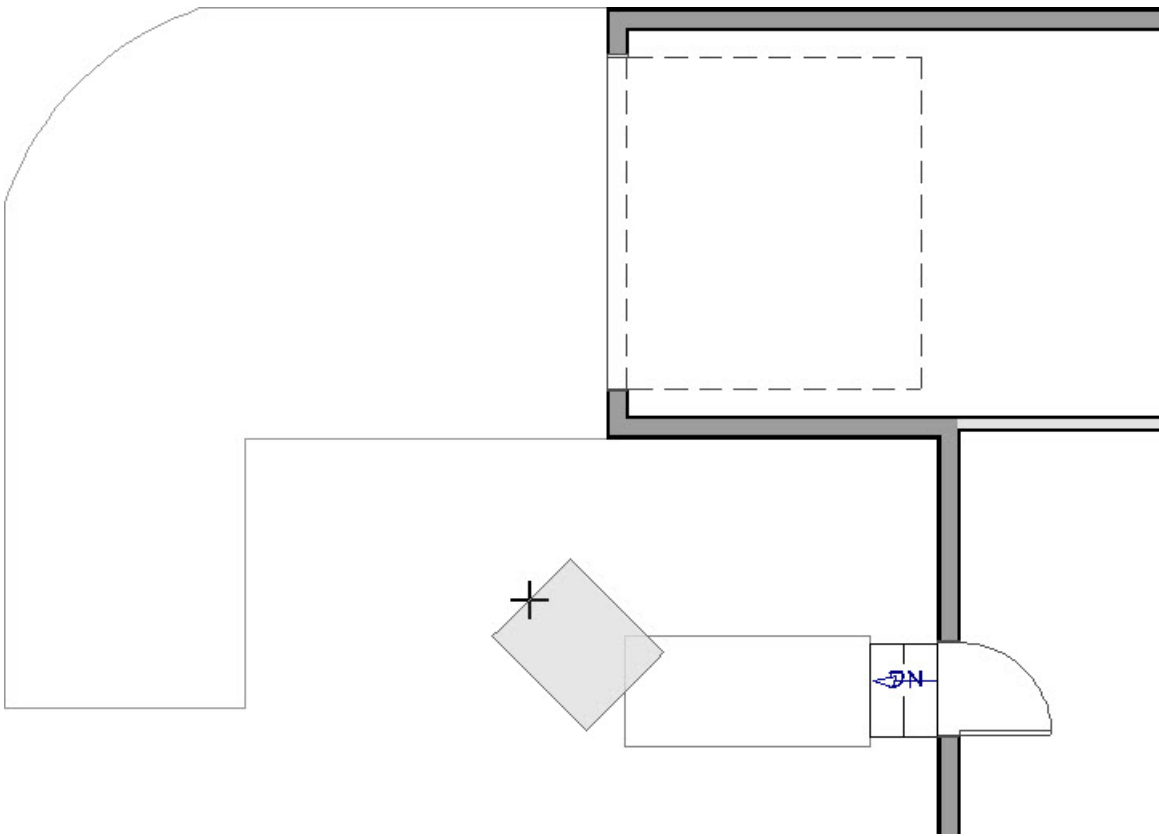

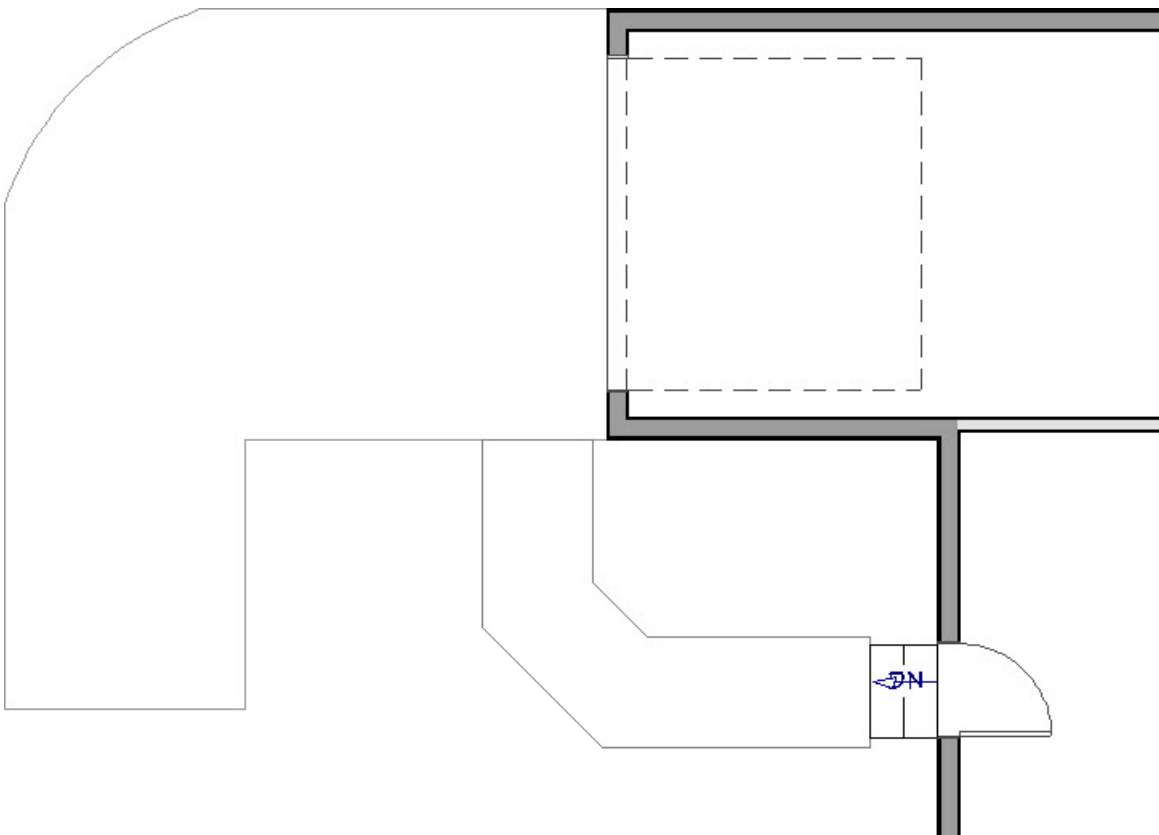

4. Click and drag the final segment to meet the driveway.



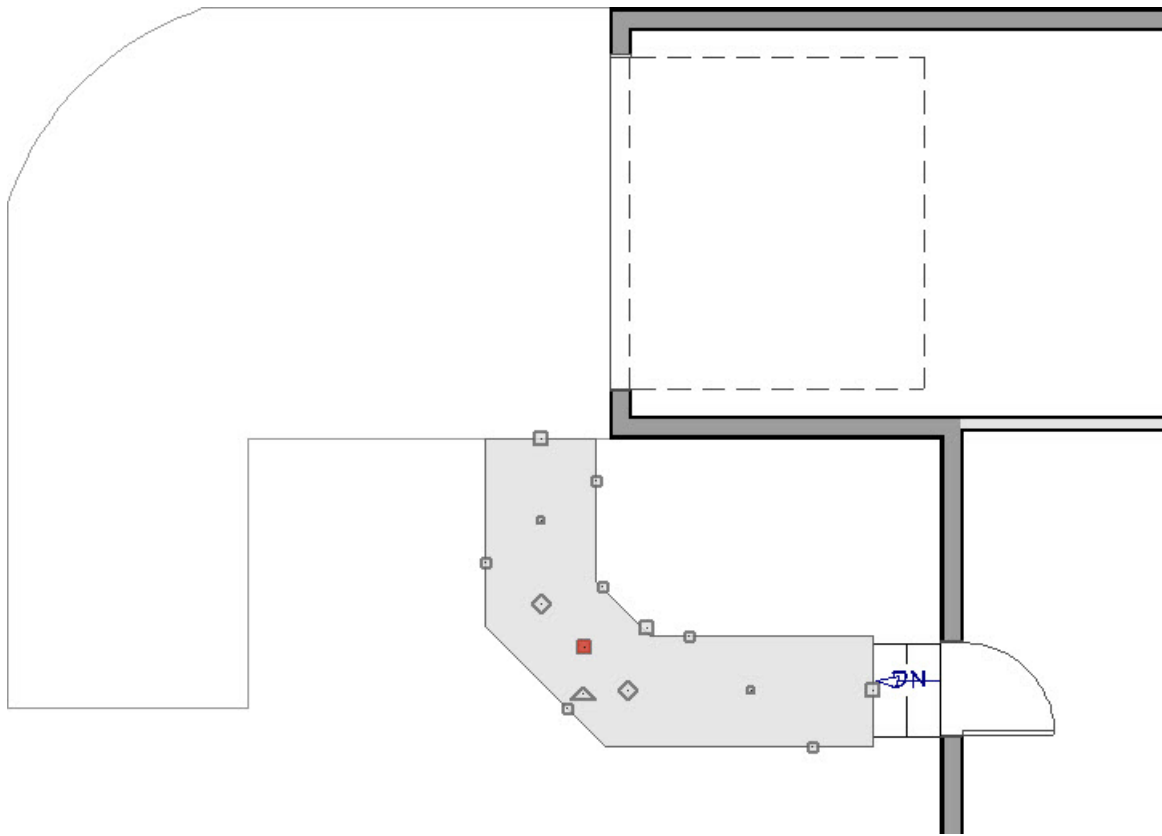

5. To curve the 45° segment:

- Select the smaller, 45° sidewalk segment.

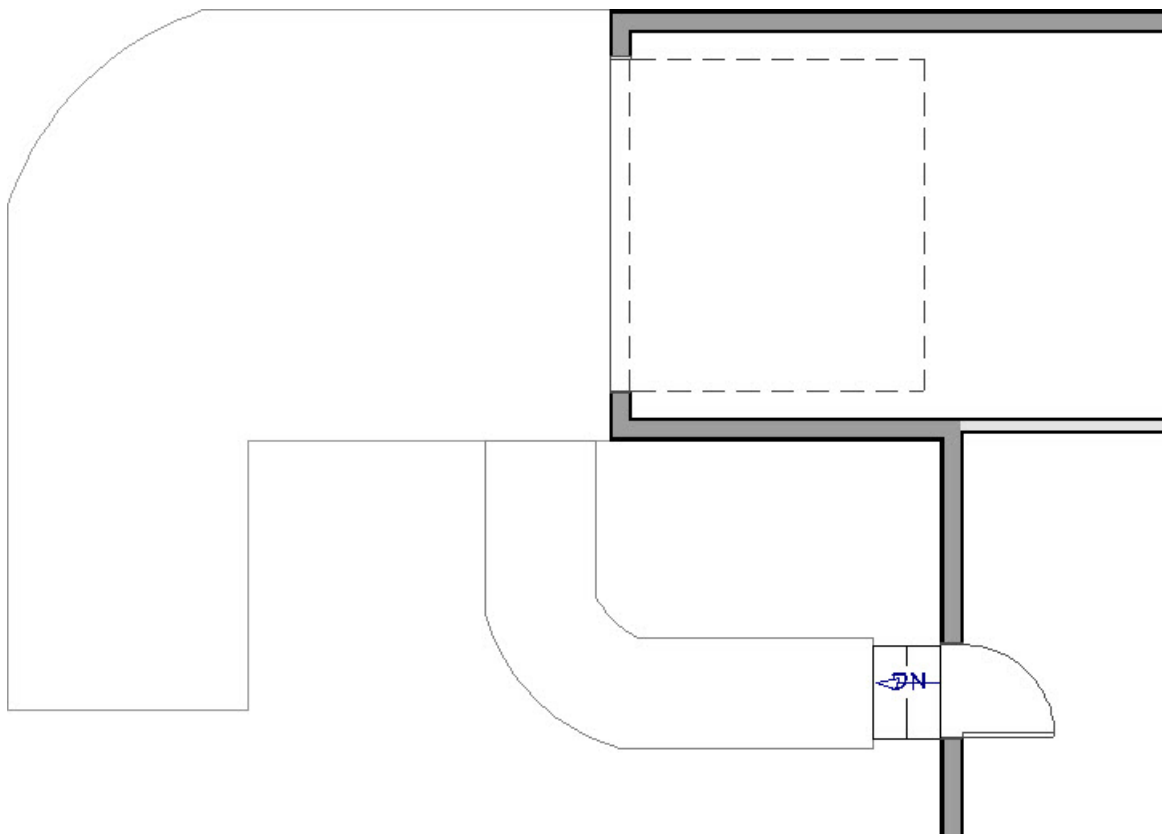

- Click the **Change Line/Arc**  tool on the Edit Toolbar.



6. With the **Select Objects**  tool, click on the sidewalk, click on **Open Object**  to open the **Terrain Path Specification** dialog where the **Thickness** and **MATERIALS** can be changed to your liking.

📄 [Creating a Garage Shop Space \(/support/article/KB-00776/creating-a-garage-shop-space.html\)](/support/article/KB-00776/creating-a-garage-shop-space.html)

📄 [Customizing Driveway and Sidewalk Materials \(/support/article/KB-00843/customizing-driveway-and-sidewalk-materials.html\)](/support/article/KB-00843/customizing-driveway-and-sidewalk-materials.html)