

# Adding a GFCI Outlet

---

Reference Number: **KB-00494**

Last Modified: **July 22, 2020**

---

The information in this article applies to:



## QUESTION

I would like to add a 110V GFCI to my plan, yet when I attempt this using the electrical outlet tool, Home Designer seems to override my selection and add a standard 110V outlet. How can I add a 110V GFCI outlet to rooms other than a bathroom?

## ANSWER

In Home Designer, a 110V GFCI outlet object can be located in the Library Browser, which can then be placed in your desired location.

To locate and place a 110V GFCI outlet

1. Select **View> Library Browser**  if the Library Browser isn't open, and navigate to **Home Designer Core Catalogs> Mechanical, Electrical, Plumbing> Electrical> Outlets> Surface Mounted**.

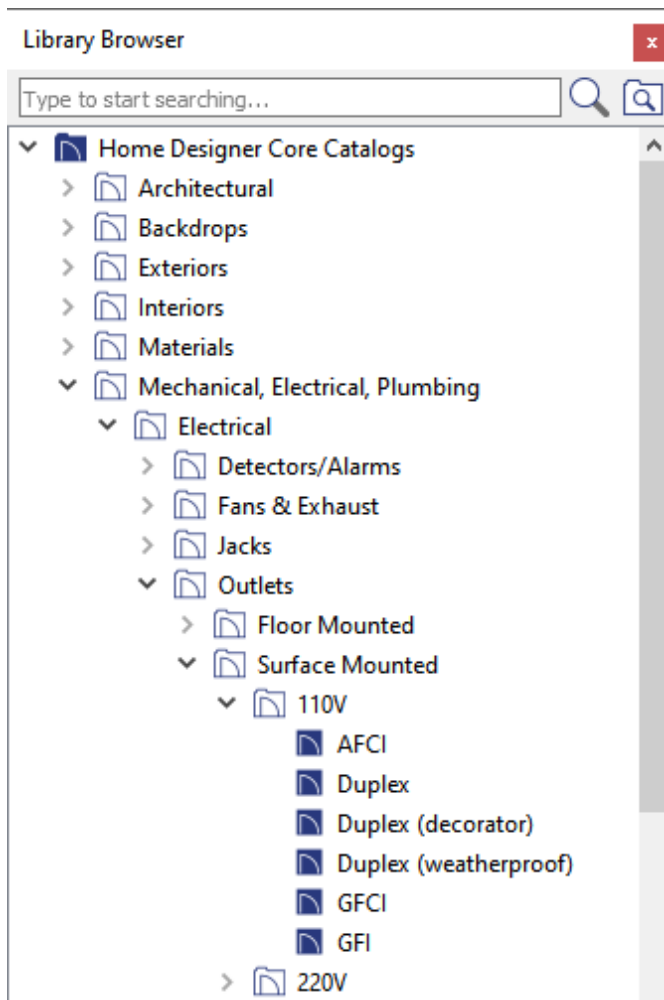

2. Select the **GFCI** outlet in the library, then click in your plan at the location you want the outlet to display.

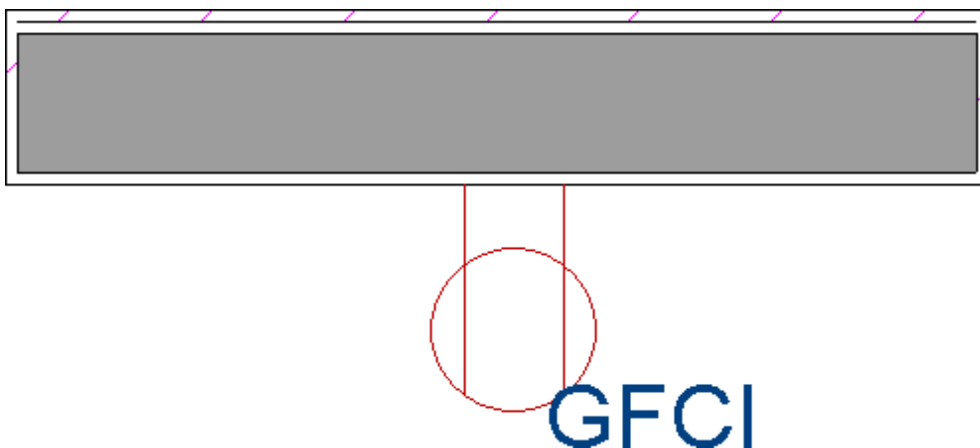

[\(https://hometalk.chiefarchitect.com/\)](https://hometalk.chiefarchitect.com/)



[\(https://chiefarchitectblog.com/\)](https://chiefarchitectblog.com/)



[\(<https://www.facebook.com/ChiefArchitect>\)](https://www.facebook.com/ChiefArchitect)



[\(<https://www.youtube.com/user/ChiefArchitectInc>\)](https://www.youtube.com/user/ChiefArchitectInc)



[\(<https://www.instagram.com/chiefarchitectsoftware/>\)](https://www.instagram.com/chiefarchitectsoftware/)



[\(<https://www.houzz.com/pro/chiefarchitect/>\)](https://www.houzz.com/pro/chiefarchitect/)



[\(<https://www.pinterest.com/chiefarchitect/>\)](https://www.pinterest.com/chiefarchitect/)

© 2003–2020 Chief Architect, Inc. All rights reserved // [Terms of Use \(https://www.chiefarchitect.com/company/terms.html\)](https://www.chiefarchitect.com/company/terms.html) // [Privacy Policy](https://www.chiefarchitect.com/company/privacy.html)

[\(<https://www.chiefarchitect.com/company/privacy.html>\)](https://www.chiefarchitect.com/company/privacy.html)