

Building a Wine Rack Using a Cabinet

Reference Number: **KB-00434**

Last Modified: **January 13, 2022**

The information in this article applies to:



QUESTION

How do I create a wine rack inside of a cabinet?





ANSWER

A wine rack is easy to create using a cabinet and the specialty storage objects located in the Core Catalogs section of the library.

In addition to creating a custom wine rack using a cabinet, you can locate additional wine accessories by accessing the [Wine Cellar Items](https://www.chiefarchitect.com/3d-library/index.php?r=site/detail/778) (<https://www.chiefarchitect.com/3d-library/index.php?r=site/detail/778>) Bonus

Catalog, the [Wine Racks America®](https://www.chiefarchitect.com/3d-library/index.php?r=site/detail/1034) (<https://www.chiefarchitect.com/3d-library/index.php?r=site/detail/1034>) Manufacturer Catalog, and the [Wineracks.com](https://www.chiefarchitect.com/3d-library/index.php?r=site/detail/799) (<https://www.chiefarchitect.com/3d-library/index.php?r=site/detail/799>) Manufacturer catalog. For more information on downloading additional library catalogs, please see the [Related Articles](#) section below.

To create a wine rack

1. Select **Build> Cabinet> Base Cabinet** , then click in your plan to add the cabinet.
2. Using the **Select Objects**  arrow tool, select the Base Cabinet and click on the **Open Object**  edit tool.
3. On the **GENERAL** panel of the **Cabinet Specification** dialog that displays, set the **Width, Height, Depth,** and **Floor to Bottom** values to your liking.
4. On the **DOOR/DRAWER** panel:

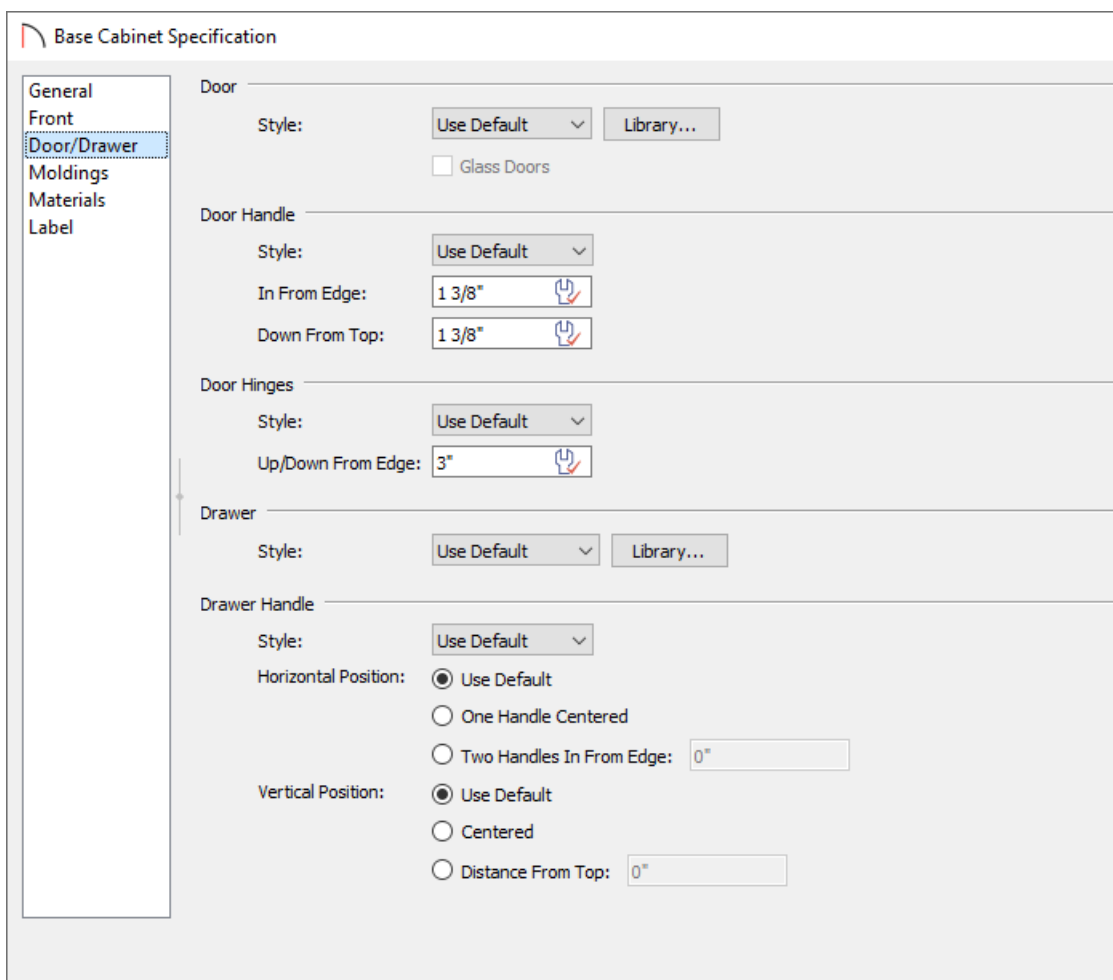

- Click on the **Library** button next to Door **Style** and in the **Select Library Object** dialog expand the list for **Cabinet Doors, Drawers, & Panels** and navigate to the **Specialty Storage** folder, where you will be able to choose an object such as a **Plate Rack** or **Wine Rack**.
- If your cabinet currently has a handle or knob, use the Door Handle **Style** drop down menu to change it to **None**.

5. Select the FRONT panel:

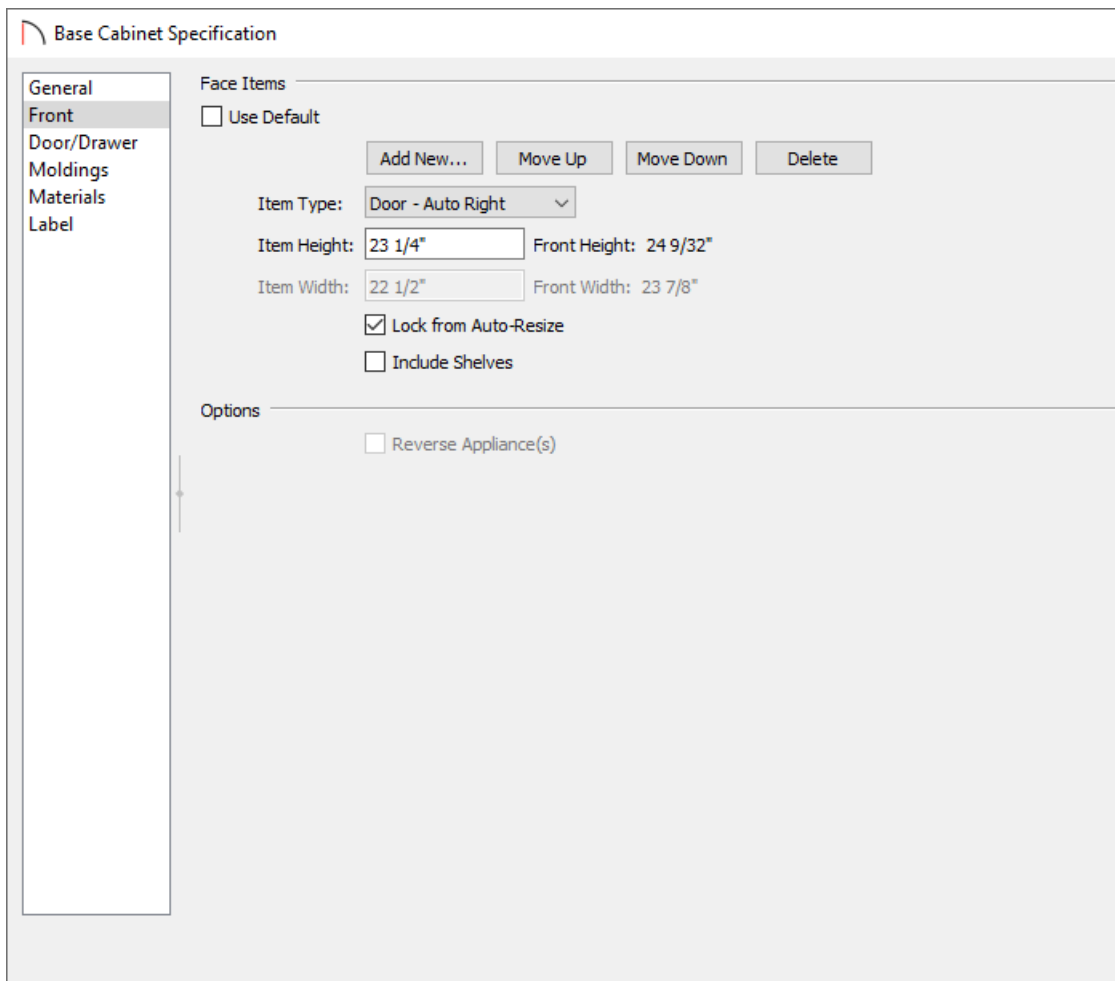

- Click on the door area in the preview panel to modify it.
- If you would like to lock the size of the wine rack face item, select the wine rack door face item using the preview panel, then check the **Lock from Auto-Resize** box.
- To remove the shelves in Home Designer Suite and Architectural, deselect **Include Shelves**.
- In Home Designer Pro, click on the **Specify** button next to the Shelves section to open the **Cabinet Shelf Specification** dialog. Select the **Manual** radio button at the top, then specify the value next to **Number of Shelves** to be **0**.

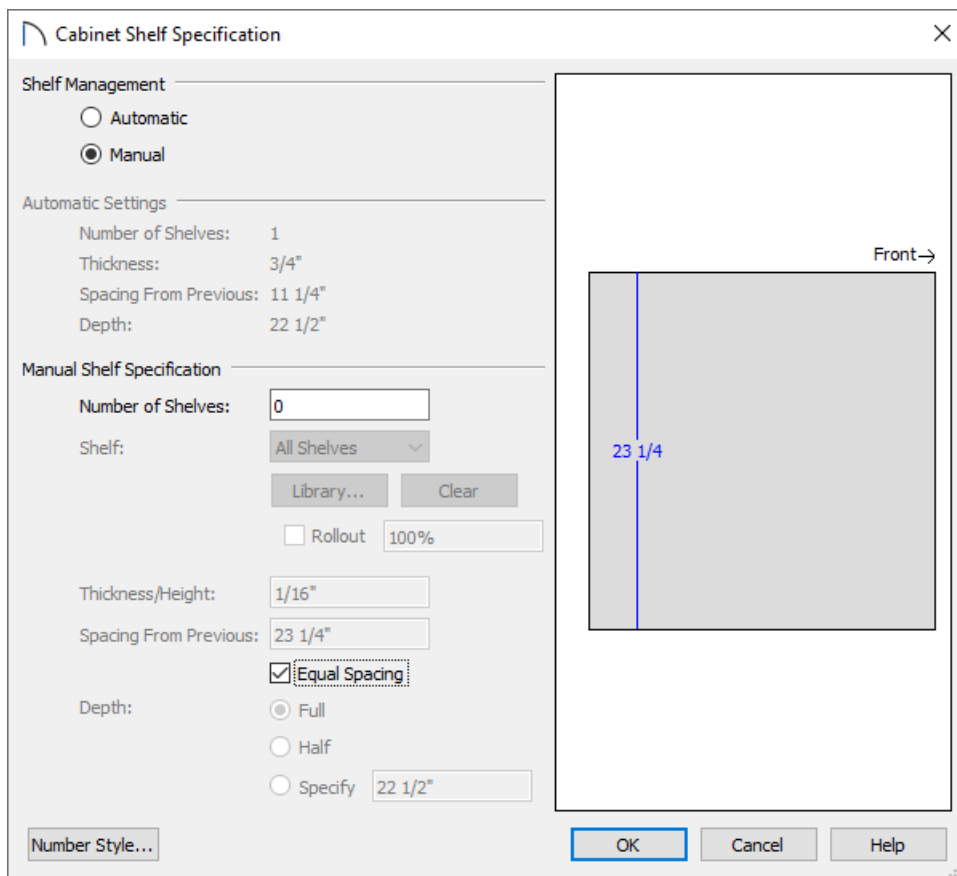

- Once all desired changes have been made, click **OK**.

6. Take a **Camera**  view to see the results.



7. Bottles from the [Wine Cellar Items](https://www.chiefarchitect.com/3d-library/index.php?r=site/detail/778) (https://www.chiefarchitect.com/3d-library/index.php?r=site/detail/778) Bonus Catalog can now be inserted into the wine rack cabinet, along with any additional wine accessories that you may want to place in your plan.

Related Articles

 [Downloading Library Catalogs \(/support/article/KB-00048/downloading-library-catalogs.html\)](/support/article/KB-00048/downloading-library-catalogs.html)