

# Creating a French Door

---

Reference Number: **KB-00134**

Last Modified: **July 14, 2021**

---

The information in this article applies to:



## QUESTION



How can I create a french door?



## ANSWER

A french door can be easily created using the Door Tools.

To create a French Door

1. Open the plan in which you would like to create a French door.
2. Select **Build> Door> Hinged Door**  from the menu and click on a wall to place a standard door at that location.
3. Click the **Select Objects**  tool, then click on the door to select it and click the **Open Object**  edit button.
4. In the **Exterior Door Specification** dialog:
  - On the **GENERAL** panel, click the **Door Style** drop-down arrow and select **Glass Panel** from the list.
  - Under **Panel Frame Options**, change the **Bottom** value to 4"

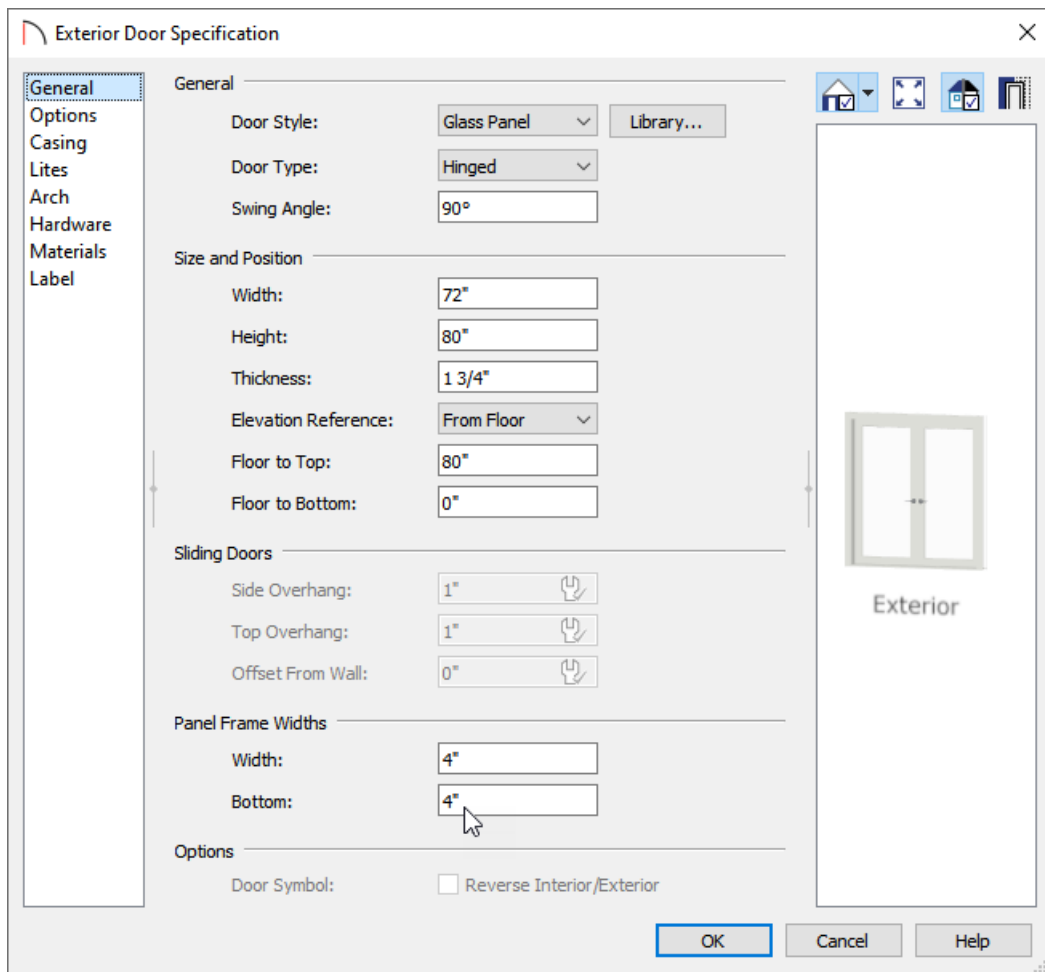

Double the Width of the door in the Door Specification dialog to automatically create a double french door at this location.

- On the **LITES** panel, change the **Lites Across** value to 3 and **Lites Vertical** to 5.

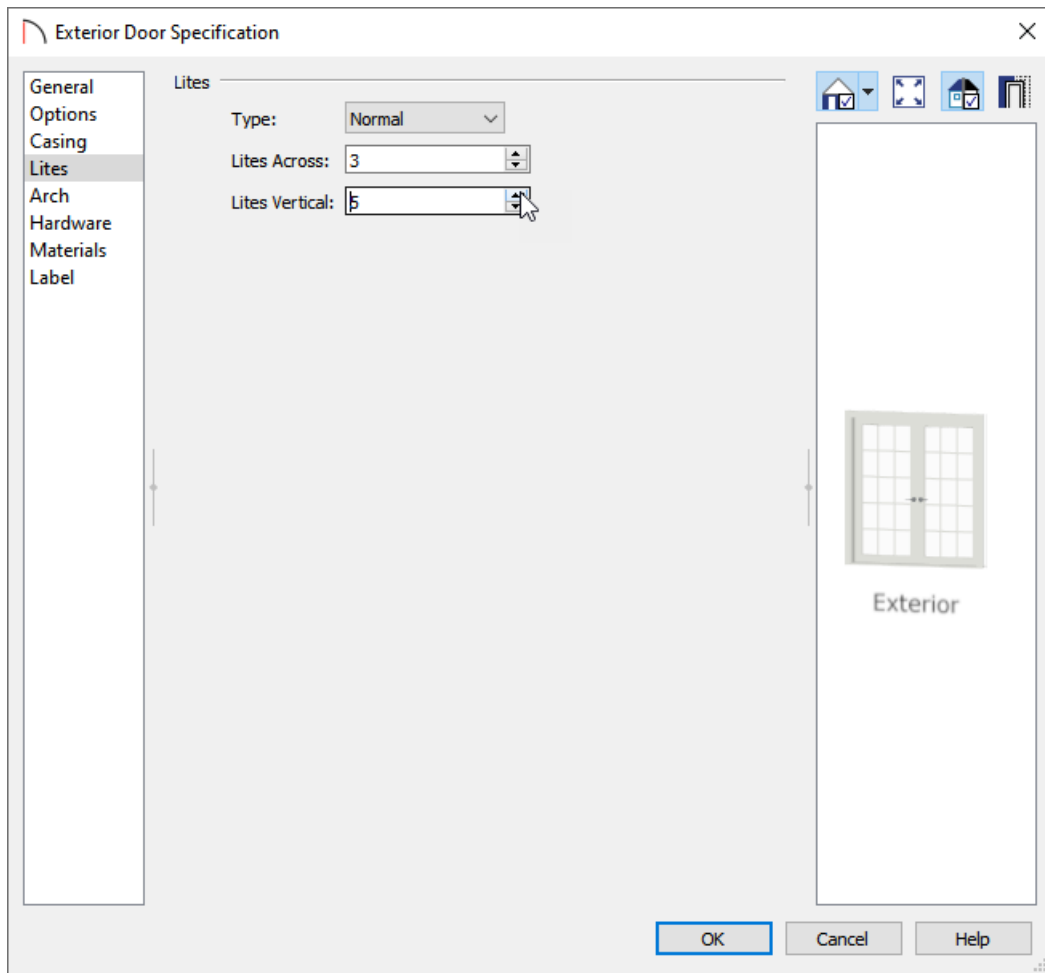

5. Click **OK** to close the dialog and apply your changes.
6. Finally, take a 3D **Full Camera**  view of the door to view the results.

---

#### Related Articles

-  [Changing the Hinge Side or Swing Direction of Doors \(/support/article/KB-00294/changing-the-hinge-side-or-swing-direction-of-doors.html\)](/support/article/KB-00294/changing-the-hinge-side-or-swing-direction-of-doors.html)
-  [Creating a Transom and Side Lites for a Door \(/support/article/KB-01262/creating-a-transom-and-side-lites-for-a-door.html\)](/support/article/KB-01262/creating-a-transom-and-side-lites-for-a-door.html)